

Slip-on collars

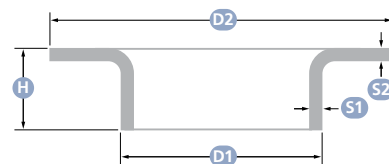

Standard: DIN 2642
Alloy: 5754

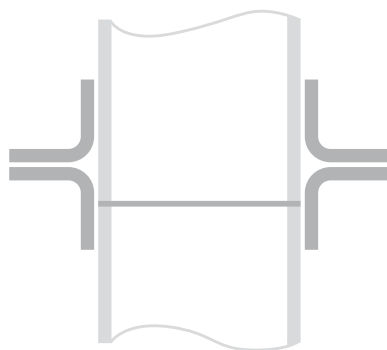

| DN | PIPE OD | D1 X S1 | D2 | S2 | H |
|-----|---------|-------------|-----|----|----|
| 50 | 60,3 | 65,8 x 2,5 | 102 | 3 | 23 |
| 65 | 76,1 | 81,6 x 2,5 | 122 | 3 | 23 |
| 80 | 88,9 | 94,4 x 2,5 | 138 | 3 | 23 |
| 100 | 108,0 | 113,5 x 2,5 | 160 | 3 | 28 |
| 100 | 114,3 | 119,8 x 2,5 | 160 | 3 | 26 |
| 125 | 133,0 | 138,3 x 2,5 | 188 | 3 | 30 |
| 125 | 139,7 | 145,5 x 2,5 | 188 | 3 | 26 |
| 125 | 139,7 | 147,5 x 3,5 | 188 | 4 | 26 |

| DN | PIPE OD | D1 X S1 | D2 | S2 | H |
|-----|---------|-------------|-----|----|----|
| 150 | 159,0 | 168,0 x 3,5 | 212 | 4 | 24 |
| 150 | 168,3 | 174,1 x 2,5 | 212 | 3 | 30 |
| 150 | 168,3 | 176,1 x 3,5 | 212 | 4 | 30 |
| 200 | 208,0 | 217,0 x 4,0 | 270 | 5 | 30 |
| 200 | 219,1 | 225,1 x 2,5 | 270 | 3 | 26 |
| 200 | 219,1 | 227,1 x 3,5 | 270 | 4 | 28 |
| 250 | 258,0 | 266,0 x 3,5 | 324 | 4 | 30 |
| 250 | 273,0 | 281,0 x 3,5 | 324 | 4 | 30 |
| 350 | 355,6 | 367,0 x 5,0 | 430 | 6 | 33 |