

# Welding collars

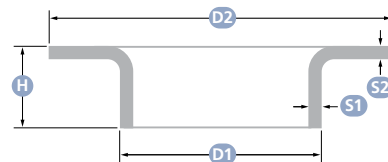

Standard: DIN 2642

Alloy: 5754

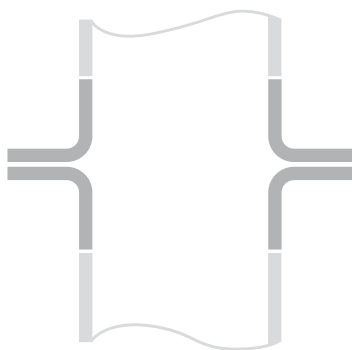

DN	D1 X S1	D2	S2	H
15	21,0 x 3	45	4	9
20	25,0 x 3	58	4	12
25	31,0 x 3	68	4	14
25	33,7 x 3	68	4	14
32	38,0 x 3	78	4	14
32	42,4 x 3	78	4	15
40	46,0 x 3	88	4	15
40	48,3 x 4	88	5	15
50	56,0 x 3	102	4	19
50	60,3 x 3	102	4	20
50	60,3 x 5	102	6	20
65	71,0 x 3	122	4	21
65	76,1 x 3	122	4	23
80	86,0 x 3	138	4	23
80	88,9 x 3	138	4	23
80	88,9 x 4	138	5	23
80	90,0 x 5	138	6	23

DN	D1 X S1	D2	S2	H
100	106,0 x 3	160	4	25
100	108,0 x 4	160	5	25
100	114,3 x 3	160	4	28
100	114,3 x 4	160	5	28
125	131,0 x 3	188	4	28
125	133,0 x 4	188	5	28
125	139,7 x 4	188	5	28
125	139,7 x 5	188	6	28
150	156,0 x 3	212	4	28
150	159,0 x 4	212	5	28
150	160,0 x 5	212	6	28
150	168,3 x 4	212	5	28
200	208,0 x 4	270	5	30
200	219,1 x 4	270	5	30
250	258,0 x 4	324	5	30
250	273,0 x 4	324	5	30
300	323,9 x 4	370	5	35